

Bloody Brook Voluntary Cleanup Update



July 2015

Lockheed Martin Mission Systems and Training
P.O. Box 4840 • Electronics Parkway • Syracuse, NY 13221-4840

BROOKVIEW LANE ROAD CLOSURE

We wish to inform you of an upcoming road closure on Brookview Lane scheduled to occur sometime in late July through August.

As you may be aware, Lockheed Martin is conducting environmental remediation activities to remove cadmium contamination along the West Branch of Bloody Brook. As part of these activities, Lockheed Martin has agreed to design and complete the replacement of five culverts that convey the West Branch of Bloody Brook under the roadways within the limits of the site. The culvert under Brookview Lane is scheduled to be replaced beginning in late July. During the replacement of the culvert, Brookview Lane will be closed to through traffic between the intersection with Midwood Drive

and the intersection with Floradale Road. Sunflower Drive will be used as a detour route, as shown on the attached figure.

In order to conduct the culvert replacement and close part of Brookview Lane, Lockheed Martin worked with the Town of Salina to develop a Maintenance and Traffic Control Plan. The work will be conducted in accordance to this plan which ensures the safety and the least amount of disturbance to the community as possible. Local organizations serving the community will all be informed of the road closure and traffic detour routes. This includes, but is not limited to, the local police, fire, bus and ambulance services, and the United States Postal Service.

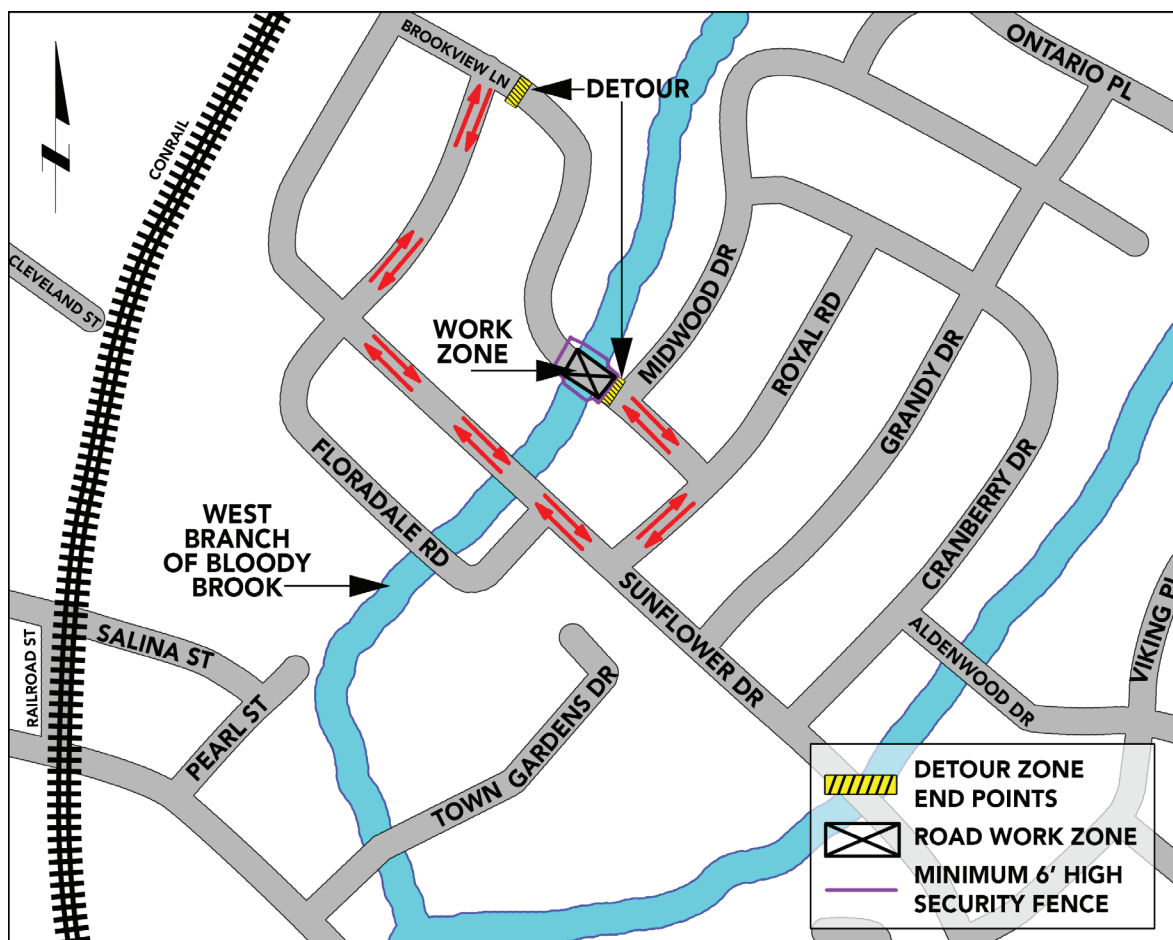

As Lockheed Martin continues remediation down the brook, four other culvert crossings (Sunflower Drive, Floradale Road, Pearl Street and Town Gardens Drive) are planned to be replaced. Each time, notices will be sent ahead of time and a traffic safety plan will be followed.

Residents with questions or concerns about the road closure or cleanup activities are encouraged to call the Bloody Brook Information Line at 315-456-2150.

Sunflower Drive will be used as a detour for the Brookview Lane closure (from the intersection with Midwood Drive to Floradale Road) as shown by the red arrows.